

18,793



Oncor Electric Delivery  
Reid Tallant  
Designer  
3873 Hwy 69N  
Greenville, TX 75401

APRIL 30, 2024

FILED FOR RECORD  
at 12:00 o'clock P M

Office of County Commissioners  
PO Box 1097 Greenville, TX 75403

MAY 14 2024

RE: Overhead Distribution Line Installation CR 1106 WO 24632618

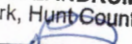
BECKY LANDRUM  
County Clerk, Hunt County, Tex.  
By 

Greetings,

Oncor Electric Delivery LLC., is requesting permission to do work within the county right of way along County Road 1106. We are looking to Install a single phase OH distribution line approximately 2' inside the north ROW of County Road 1106. Site location map and permit exhibit are enclosed. The permit exhibit details the proposed work. If you have any questions, please contact at any time.

Sincerely,

Reid Tallant  
Designer

**ONCOR SCOPE OF WORK**

**WS2  
INSTALL DE ANCILLARIES  
RUN 2 AAAC TO WS3**

**WS3  
INSTALL DE 40/3 POLE  
INSTALL 25 KVA XFMR  
RUN SERVICE TO METER**

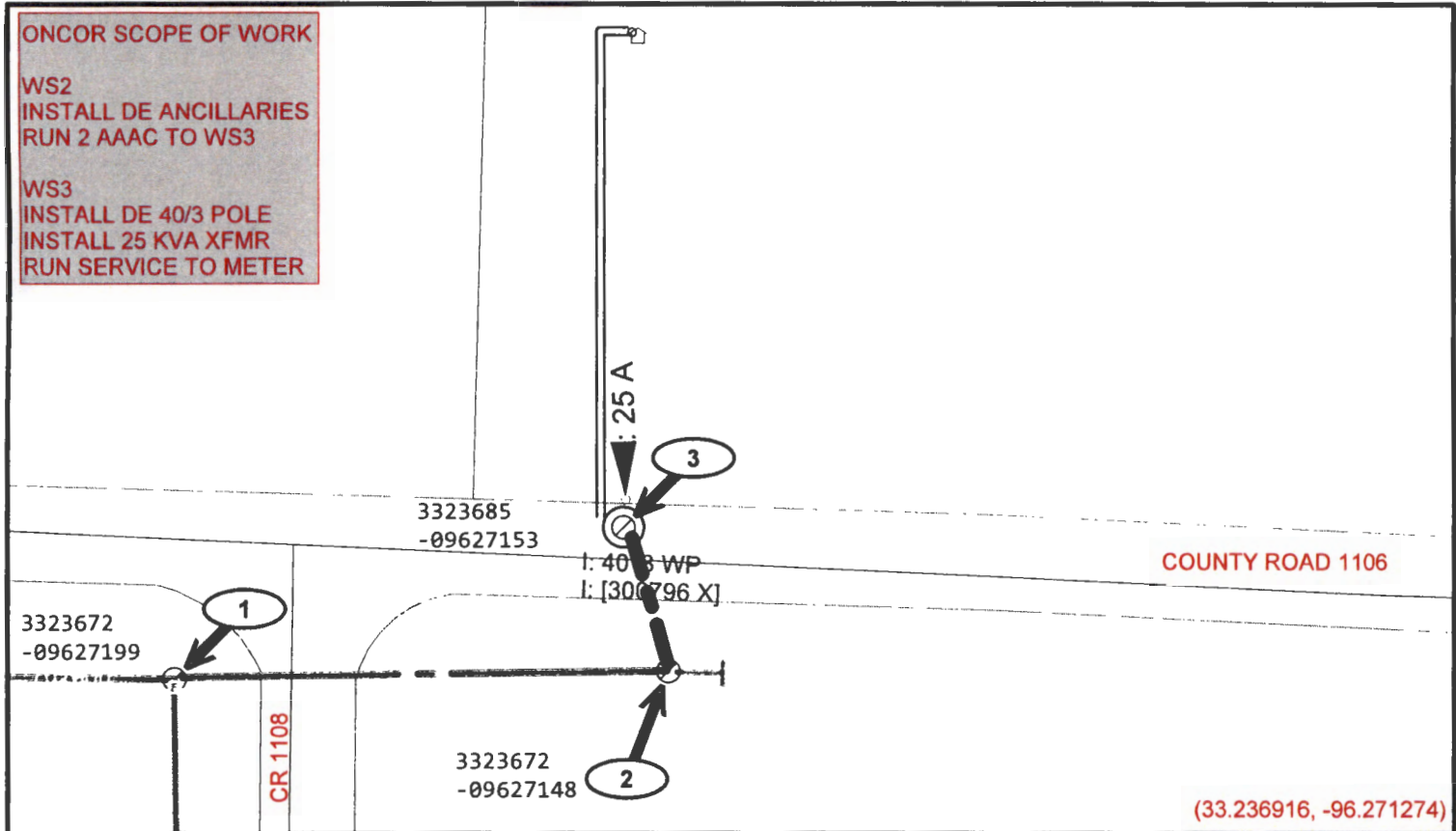

**ELECTRIC CONSTRUCTION PRINT**

WO Number: **24632618-01**      Date: 2024/04/29      Description: Luke 3499 cr 1106 Celeste 75423  
Sheet: **1** of **1**      Scale: [SCALE]      Customer: Luke Merritt 214.385.3118  
Job Status: Design      Svc Ctr / Office: CEL/CEL      Address: 3499 County Road 1106 CELESTE, TX 75423  
Designer: REID TALLANT/UBAV      469-836-4662      Location:  
Project Mgr: REID TALLANT/UBAV      469-836-4662

**Voltage: 24.9**  
**Feeder ID: SWNDL2104**  
**Protective Device ID: 419855**

Copyright 2018 Oncor Electric Delivery - Maps, drawings, and electronic data (products) are created for the internal purposes of Oncor Electric Delivery with no implication of suitability or fitness for the intended use of the recipient. Oncor Electric Delivery will make good faith efforts to provide products that are free from error, but does not warrant the accuracy or quality of such products. The locations shown are approximations and are not intended to show exact locations. Products provided to other parties by Oncor Electric Delivery are for the internal use of the recipient, and the recipient agrees not to duplicate or distribute the products or any portion of the products to third parties without the prior written permission of Oncor Electric Delivery. The recipient further agrees to hold harmless and indemnify Oncor Electric Delivery against all claims, costs, expenses and damages resulting from or predicated upon strict liability for personal injuries, death or property damage, on account of any defect in the property provided hereunder.